

# NOOREVA

## AIR ACTIVE 101 ANC

User Manual

### Diagrammatic Sketch

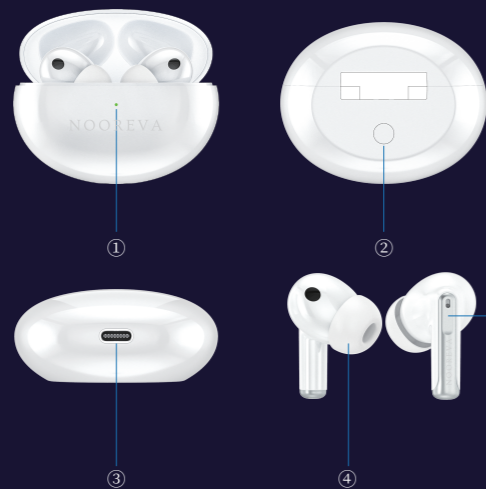

### Specifications

- Model: AIR ACTIVE 101 ANC
- Working time: 3 hours
- Bluetooth version: V5.1+EDR
- Working voltage: 3.3V-4.2V
- Earbud battery:30mAh
- Charging time: 70 minutes
- Charging case battery:400mAh
- Speaker impedance: F10/32Ω
- Power input:5V
- Frequency response: 20-20KHZ
- Product weight: about 37g
- Transmission distance:over 10 meters

### Package List

- Bluetooth headset (2PCS)
- Earphone Charging box
- Type-c charging cable
- User's manual
- Gift package
- Earphone caps (3 pairs)



### How to use

#### 1. The boot

Automatic startup (first use)  
Step 1: Open the top cover of the charging bin.  
Step 2: Take out the earphone. At this time, the earphone will start up automatically and wait to connect the phone.  
Manual boot  
The earphone is not in the charging bin and the earphone is off. Press left and right for 3 seconds to start the earphone.

#### 2. To turn it off

Automatic earphone shutdown  
Step 1: Remove the earphones from your ears after use.  
Step 2: Put the left and right earphones into the charging bin,close the cover of the charging bin,and it will automatically shut down and charging.  
Manually turn it off  
Step 1: If the earphones are turned on and connected to each other, click either ear The machine shuts down in 5 seconds.  
Step 2: Put the left and right earphones into the charging bin, close the cover of the charging bin, shut down and charge.

#### 3. Bluetooth pairing

Step 1: Take the earphones out of the charging bin.  
Step 2: Turn on bluetooth.  
Step 3: Find the headset bluetooth name [AIR ACTIVE 101 ANC].  
Step 4: Click Connect, voice reminder after successful connection.

Note:If there is pairing device information,the headset will automatically connect to the device within 2-4s. If the headset is not connected to the device,it will automatically shut down after three minutes of standby.

#### 4. Operation of earphone

(A) Chinese and English voice switching:  
When the headset is powered on, there is no bluetooth connection. Double-click to switch to English.  
(B) Answer/Hang up:  
Click any headset to answer/end the call.  
Hold down either earphone for 1.5 seconds to refuse to answer the call.  
(C) Pause/play:  
Click either earphone to pause or play the music.  
(D) Previous/next:  
During the music playing, double click the left earphone to complete the operation of the previous song.  
Double-click the headset on the right during the music playing to complete the next song operation.  
(E) Volume increase and decrease:  
Tap the left earphone three times to increase the volume.  
Click the right earphone three times to reduce the volume.  
(F) Wake up the voice assistant:  
After setting permissions on the IOS phone and screening SIRI functions, hold down the headset for 1.5 seconds to wake up SIRI.  
(G) Ear test:  
Put on the headphones and play the music. Take them off and pause the music.  
(H) Noise reduction:  
Noise reduction mode: Hold down the left and right earphones for 2 seconds to switch from transparent mode to noise reduction mode  
Transparent mode: Hold down the left and right earphones for 2 seconds to switch from noise reduction mode to transparent mode

The latest IOS system default transparency - noise reduction switch  
Table mobile phone default noise reduction on - noise reduction off - transparent mode three modes cycle switch

### Indicator working status

Working status	Indicator status
Put earbuds into charging case	The green breaths for one second
Charging for charging cas	The orange lights for 10 seconds
Full of charging	The Green lights for 4 seconds
Open the cover of charging case	The green lights for 10 seconds
Close the cover of charging case	The green lights for 3 seconds

Key functions:

1. Short press the button,lamp will flash
  2. Long press the button to match the headset, and the green light will be on for 1 second after the headset is paired successfully
- Noise reduction test steps:
1. Put the product to be tested into the product rack inside the test shielding box
  2. Close the shielding box after placing it
  3. Then click test software to start testing

### Precautions for use

1. Headphones should be stored in a dry and ventilated environment to avoid contact with oil, water vapor and steam.In order to avoid affecting product performance.
2. Avoid cleaning with irritating, organic solvents or materials containing these ingredients.
3. The headset should be used according to the correct specification requirements,and pay attention to the influence of the using environment on the headset.  
To ensure smooth connection, it is recommended that the distance between the mobile phone and the earphone be within 10 meters.
4. If the earphone fails to connect or communicate properly, do not remove the earphone without permission  
The machine body and its accessories are not guaranteed otherwise.
5. To charge the earphone, please use the standard car charger or the one specified by our company Chargers required.
6. To ensure normal use of the earphone, ensure that the power of the earphone is sufficient.